

Shackles | .33 - 150 Ton | Bolt Type

- Working Load Limit permanently shown on every shackle.
- Forged – Quenched and Tempered, with alloy pins.
- Capacities 1/3 thru 55 metric tons.
- Look for the Red Pin®...the mark of genuine Crosby quality.
- Shackles 55 metric tons and smaller can be furnished proof tested with certificates to designated standards, such as ABS, DNV, Lloyds, or other certification.
- Certification must be requested at time of order.
- Shackles 85 metric tons and larger can be provided as follows: Non Destructive Tested, Serialized Pin and Bow, Material Certification (Chemical), Certification must be requested at time of order.
- Hot Dip galvanized or Self Colored.
- Fatigue rated.

Specifications				
Nominal Shackle Size (in)	Working Load Limit* (t)	Model		2130 Weight Each (lbs)
		G-2130 Galv.	S-2130 S.C.	
1 3/4	25	1019659	1019668	33.91
2	35	1019677	1019686	52.25
2 1/2	55	1019695	1019702	98.25
3	† 85**	1019711	—	154.00
3 1/2	† 120**	1019739	—	265.00
4	† 150**	1019757	—	338.00

Green shading reflects rental inventory.

G-2130 S-2130

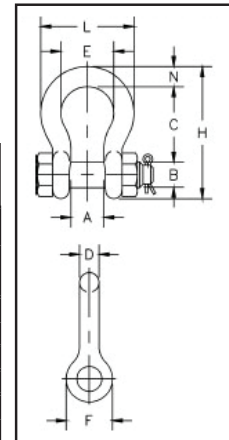

Dimensions													
Nominal Shackle Size (in)	Working Load Limit* (t)	Dimensions (in)										Tolerance + / -	
		A	B	C	D	E	F	H	L	M	N	C	A
1 3/4	25	2.88	2.04	7.00	1.84	5.00	4.19	12.34	8.80	9.68	2.25	.25	.13
2	35	3.25	2.30	7.75	2.08	5.75	4.81	13.68	10.15	10.81	2.40	.25	.13
2 1/2	55	4.13	2.80	10.50	2.71	7.25	5.69	17.90	12.75	13.58	3.13	.25	.25
3	† 85**	5.00	3.30	13.00	3.12	7.88	6.50	21.50	14.62	15.13	3.62	.25	.25
3 1/2	† 120**	5.25	3.76	14.63	3.62	9.00	8.00	24.88	17.02	17.00	4.38	.25	.25
4	† 150**	5.50	4.26	14.50	4.00	10.00	9.00	25.68	18.00	17.75	4.56	.25	.25

*Note: Maximum Proof Load is 2.0 times the working load limit. Minimum ultimate strength is 6 times the working load limit.

**Furnished in Anchor style only.

+ Individually Proof Tested with certification and furnished with round head bolts with welded handles.